

## DW Sports moves for Fitness First clubs

The long-running saga of the sale of Fitness First's UK clubs looks to be in its final act, as up to five operators are understood to have completed separate deals to buy out the nearly 70-strong portfolio – with DW Sports leading the way.

The deals, expected to be confirmed by Fitness First owner Oaktree Capital later this month, will see Fitness First carved up by DW Sports, The Gym Group and GLL (Greenwich Leisure Ltd) – while other firms are circling.

DW Sports, owned by multimillionaire Dave Whelan, is expected to pick up a total of 63 clubs, nearly doubling its existing number of clubs operated under the DW Fitness banner.

Whelan confirmed the business is “getting 63 health clubs which are mainly in the south of England where we do not



Whelan is optimistic the move would not be scuppered by competition authorities

have so much of a presence” in an interview with the *Wigan Evening Post*.

With DW Sports boasting a strong selection of northern locations and Fitness First having a significant presence in affluent areas of the

south – particularly London – a successful deal would see the UK's second largest health club chain boast an enviable spread of sites.

The former Wigan Athletic chair also said he “wasn't expecting any trouble from the competition people” in terms of the deal, with the geographical differences between DW Sports and Fitness First reducing the likelihood of intense scrutiny from the Competition and Markets Authority (CMA), which previously proved the downfall of a proposed merger between Pure Gym and The Gym Group.

If the deal goes through, it will immediately make DW

Sports – which has around 80 sites – one of the largest private gym chains in the UK, rivaling current market leader Pure Gym, which currently has more than 160 clubs.

Details: <http://lei.sr?a=X6O9m>

### FA ramps up grassroots facilities programme

The Football Association (FA) is awaiting the green light to build grassroots football hubs in Liverpool and West London after establishing facilities in Sheffield.

New centres have launched in the South Yorkshire city as part of a pilot for the Parklife Football Hub Programme, which is being funded by the FA, Sheffield District Council and the Department of Culture, Media and Sport (DCMS).

St George's Park Sheffield Graves was one of the first sites to open.

*Continued on back cover*

## Sugar levy should pay for activities

The hundreds of millions of pounds the government is expecting to generate as a result of its soft drinks sugar levy should be pumped into physical activity initiatives outside schools as well as within them, according to Baroness Tanni Grey-Thompson.

Launched last month, the government's obesity strategy set out its plan for physical activity within schools, encompassing a recommendation of 30 minutes of dedicated time every day, funded by the levy. The levy – which will be applied to all soft drinks with a certain amount of sugar – is expected to generate £520m (US\$684.6m, €604.9m) for the Treasury.



Grey-Thompson urged the government to spend the revenue on physical activities outside school time

However, ukactive chair Grey-Thompson stressed that while it was “encouraging” that schools were being encouraged to promote physical activity, with Ofsted monitoring progress, a slice of the fund should be earmarked for initiatives during the school holidays.

Details: [http://lei.sr?a=T8Y4B\\_O](http://lei.sr?a=T8Y4B_O)

**GET  
LEISURE  
OPPS**

**Magazine** sign up at  
[leisureopportunities.co.uk/subs](http://leisureopportunities.co.uk/subs)

**Job board** live job updates  
[leisureopportunities.co.uk](http://leisureopportunities.co.uk)

**PDF** for iPad, Kindle & smart phone  
[leisureopportunities.co.uk/pdf](http://leisureopportunities.co.uk/pdf)

**Ezine** sign up for weekly updates,  
[leisureopportunities.co.uk/ezine](http://leisureopportunities.co.uk/ezine)

**Online** on digital turning pages  
[leisureopportunities.co.uk/digital](http://leisureopportunities.co.uk/digital)

**Instant** sign up for instant alerts,  
[leisureopportunities.co.uk/instant](http://leisureopportunities.co.uk/instant)

**Twitter** follow us:  
[@leisureopps @leisureoppsjobs](https://twitter.com/leisureopps)

**RSS** sign up for job & news feeds  
[leisureopportunities.co.uk/rss](http://leisureopportunities.co.uk/rss)

The Leisure Media Company  
Portmill House, Portmill Lane,  
Hitchin, Herts SG5 1DJ, UK  
Tel: +44 (0)1462 431385  
Fax: +44 (0)1462 433909  
e-mail: please use contacts'  
fullname@leisuremedia.com

### Subscriptions

subs@leisuremedia.com

### Editor

Liz Terry 01462 431385

### Head of News

Matthew Campelli 01462 471912

### Journalists

Tom Anstey 01462 471916

Jane Kitchen 01462 471929

Kim Megson 01462 471915

### Products Editor

Kate Corney 01462 471927

### Design

Ed Gallagher 01905 20198

### Internet

Michael Paramore 01462 471926

Dean Fox 01462 471900

Tim Nash 01462 471917

Emma Harris 01462 471921

### Publisher

Julie Badrick 01462 471919

### Associate Publisher

Paul Thorman 01462 471904

### Associate Publisher/ Property Desk

Simon Hinksman 01462 471905

### Account Manager

Chris Barnard 01462 471907

Jed Taylor 01462 471914

### Financial Administrator

Denise Adams 01462 471930

### Circulation Manager

Michael Emmerson 01462 471932

### Subscribe to Leisure Opportunities,

Online: [www.leisuresubs.com](http://www.leisuresubs.com)

Email: [subs@leisuremedia.com](mailto:subs@leisuremedia.com)

Tel: +44 (0)1462 471930

Annual subscription rates are: UK £34,

Europe £45, Rest of world £68, students UK £18.

Leisure Opportunities is published 26 times a year by The Leisure Media Co Ltd, Portmill House, Portmill Lane, Hitchin, Herts SG5 1DJ, UK. The views expressed in this publication are those of the author and do not necessarily represent those of the publisher The Leisure Media Co Ltd. All rights reserved. No part of this publication may be reproduced, stored in a retrieval system or transmitted in any form or by means, electronic, mechanical, photocopying, recorded or otherwise, without the prior permission of the copyright holder, Cybertrek Ltd. Printed by Warners Midlands PLC. Distributed by Royal Mail Group Ltd and Whistl Ltd in the UK and Total Mail Ltd globally. ©Cybertrek Ltd 2016 ISSN 0952/8210 (Print). ISSN 2397-2394 (Online).

## SPORT

# £33m Oriam centre opens

A £33m sporting facility in Scotland has opened at Heriot-Watt University's Edinburgh campus. The national sports performance centre has been backed by £24m from the Scottish Government and £9m from partners, sportscotland, Heriot-Watt University and Edinburgh City Council.

The partners include the Scottish FA, Scottish Rugby, Basketball Scotland, Netball Scotland, Scottish Handball, sportscotland Institute of Sport and Scottish Squash and Racquetball.

The new multi-purpose development aims to be a collaborative environment to support Scotland's up-and-coming sportsmen and women, their coaches and volunteers, to train and prepare for competition at the highest levels. The centre will also welcome students, staff, the local community and sports groups.

Facilities include a Hampden Park standard grass pitch, an outdoor synthetic pitch, four outdoor natural grass football



The facility will act as Scotland's national sports performance centre

pitches, two rugby pitches, a 12-court sports hall, a 120-station fitness suite, a café and private dining area.

Other facilities on the site include a four-court sports hall with climbing wall, two newly developed exercise studios, eight squash courts, including Scotland's only glass back show court, video analysis facilities, an indoor 3G synthetic pitch, The Heart of Midlothian Football Academy and a jogging course.

Details: [http://lei.sr?a=x4k8E\\_O](http://lei.sr?a=x4k8E_O)

## Sport strategy triggers CIMSPA review

CIMSPA, the professional body for the UK sport and physical activity sector, has set out to undertake a full governance review as it bids to fulfil its responsibilities set out in the government sport strategy.

The review is being led by Anthony Collins Solicitors and is consulting across the sector, taking in submissions from industry stakeholders such as the Royal College of Physicians, Sport England and ukactive. Concluding later this month (September), the review will end with the recruitment of a permanent chair following the exit of David Stalker, who spent six years with the body.

Andy Reed, the former Labour MP who recently delivered a review on the County Sports Partnerships (CSP), will take over as the organisation's chair in the interim.

CIMSPA – the Chartered Institute for the Management of Sport and Physical Activity – was tasked by the government in its *Sporting Future* blueprint to develop a “single, clear and rigorous set of standards” for all sport and exercise professionals with the help of grassroots quango Sport England.

As a result, Sport England ceased to fund fellow professional body SkillsActive.



CEO Tara Dillon said there was ‘work to be done’

Tara Dillon, CIMSPA chief executive, said that the body had “changed beyond all recognition” under the stewardship of Stalker but the “hard work doesn't stop here”.

“To continue to attract investment in the sector we need employers to take a place at the table and deliver workforce development plans,” she added.

Details: [http://lei.sr?a=E6q7B\\_O](http://lei.sr?a=E6q7B_O)



## Equality in sport a 'long way off'

Disabled people do not have adequate access to grassroots sport clubs and facilities and there is a "long way to go" before the situation improves, said the chief executive of the British Paralympic Association (BPA).

According to Tim Hollingsworth, there are still barriers to participation for disabled people because of limited physical accessibility to grassroots sporting infrastructure and the inability of some clubs to integrate individuals effectively.

Talking to *Leisure Opportunities* ahead of the Rio 2016 Paralympic Games, Hollingsworth said that since the transformational London 2012 Games – in which Team GB won 120 medals – facilities had improved and participation had increased at disability-specific sports clubs, but work needed to be done to improve the experience at mainstream sports clubs.

"I still think we have a long way to go in the general accessibility of sport within



Hollingsworth said he was encouraged that the government sport strategy would increase opportunities for disabled people

local communities for disabled people," said Hollingsworth. "Clubs and local authorities should be asking 'is it actually possible for disabled people to play sports with the facilities that are available?'"

"There's also an issue around social accessibility; can clubs offer adequate opportunities? Do they have the coaches to integrate disabled people? I don't think there's anything like the cumulative evidence you'd want to see."

Details: [http://lei.sr?a=s2u5P\\_O](http://lei.sr?a=s2u5P_O)

## 'House of Sport' to be established

Organisations in the sport sector are being invited to move into the 'House of Sport' – a London-based office designed to facilitate collaboration and efficiencies.

The concept – devised by London Sport – will see several sport and physical activity organisations work under the same roof across three floors of an office in the capital's Dover Street.

London Marathon has provided the space, which will be run as a not-for-profit venture, with money generated from rent reinvested in services which help the organisations "promote increased levels of physical activity and wellbeing".

Around 150-200 people will be able to occupy the office at any one time. The facility will provide shared networking space and "collaborative hot desking". Organisations that wish to apply for space in the facility must fill out an expression of interest form ahead of the office's official opening in early 2017.

Peter Fitzboydon, London Sport CEO, said the initiative was a "landmark opportunity" for firms in the sector to collaborate and promote physical activity in London.



Peter Fitzboydon said the initiative was a landmark opportunity

London Sport has its own objective of getting one million more Londoners physically active by 2020. "The House of Sport project is a once-in-a-generation opportunity to provide a practical solution to inspiring new opportunities in the capital," Fitzboydon said.

"This new venture will have a real impact on saving money and reducing wasteful bureaucracy for the numerous organisations that make up our sector in London," added London Sport chair Kate Hoey.

Details: [http://lei.sr?a=p2r5Z\\_O](http://lei.sr?a=p2r5Z_O)

## AFC Wimbledon given a clear path to new stadium

AFC Wimbledon's proposal to build an 11,000-capacity stadium close to its spiritual Plough Lane home has moved a step closer as a result of the Mayor of London declining to intervene in the planning process.

Sadiq Khan wrote to Merton Borough Council to clear the local authority to make a decision on the League One football club's proposal itself, without the input of City Hall, following a short consultation period.

The move to develop the £20m complex – which will also include more than 600 residential homes and a range of leisure facilities – appears now to be a formality and will go ahead.

Details: [http://lei.sr?a=H8j2K\\_O](http://lei.sr?a=H8j2K_O)



The race will take place across Yorkshire

## Government makes Road World Championships bid

The government has followed through with its commitment to bid for the UCI Road World Championships – and has set aside £24m to host it in Yorkshire.

The proposal was first revealed in last year's Autumn Statement as part of chancellor George Osborne's Northern Powerhouse strategy, in which rugby league was also pledged financial backing and a 2021 World Cup bid.

Welcome to Yorkshire put the bid together in association with British Cycling and UK Sport, although the Treasury has "guaranteed to underwrite the full cost".

North, south, east and west Yorkshire will all feature in the race route, and the competition will take place over three days with the full road race and races for under-18s and under-23s.

The county hosted a stage of the Tour de France in 2014 – and event which generated millions of pounds for the local economy.

"Yorkshire has everything a bike race could wish for," said Sir Gary Verity, Welcome to Yorkshire chief executive.

Details: [http://lei.sr?a=b9P7d\\_O](http://lei.sr?a=b9P7d_O)

### Fitbit unveils latest edition of tracker wristbands

Tech firm Fitbit has launched its latest fitness wristbands – Charge 2 and Flex 2.

Charge 2 features a heart rate tracking tool, has a large display area and allows for interchangeable bands. Charge 2's heart rate tracking tool makes it easier to maximise workouts, better track calorie burn and get a better picture of overall health.

Flex 2 is a swim-proof fitness wristband and is water resistant up to 50 meters. It tracks pool swims including laps, duration and calories burned in the Fitbit App. Its SmartTrack automatically recognises workouts, such as walks, runs, rides, elliptical, sports, aerobic workouts, and swims.

Details: [http://lei.sr?a=e8p2Z\\_O](http://lei.sr?a=e8p2Z_O)



The Newbold Comyn centre will be upgraded

### Warwick council to invest £12m in two leisure centres

Warwick District Council plans to invest £12m in two leisure centres over the next 18 months, with an external contractor to be appointed to manage its facilities.

The cash will be invested in Newbold Comyn and St Nicholas Park centres.

The Newbold centre in Leamington will include extensions, as well as alterations to the existing leisure centre building. There will be a bigger entrance foyer, a four-court sports hall, wet change facilities, refurbished dry facilities, a climbing zone, three multi-use studios and a larger fitness suite.

Plans at St Nicholas Park in Warwick include an extension together with internal and external alterations to the existing leisure centre building. There will be a new entrance foyer, new wet and dry change facilities, a spin studio, two multi-use studios and a bigger fitness suite.

Warwick District Council currently has six leisure centres and it has stated that by appointing an external operator, it will be able to retain some control over pricing and access for local clubs and organisations.

Details: [http://lei.sr?a=J3W9S\\_O](http://lei.sr?a=J3W9S_O)

## Experts criticise obesity strategy

Experts and campaign groups have poured scorn on the government's *Childhood Obesity Strategy*, describing it as a "missed opportunity", "embarrassing" and "too weak".

The government released the 13-page document on 18 August, as part of a strategy to significantly reduce England's rate of childhood obesity within the next ten years.

Key points in the strategy include the introduction of a soft drinks industry levy across the UK and the recommendation that children should have at least 60 minutes of physical activity every day, with 30 minutes in schools and the other half-hour during home time.

The food and drinks industry has also been challenged to cut sugar in products by at least 20 per cent by 2020, including a 5 per cent reduction over the next year.

However, the strategy has been roundly criticised for not going far enough.

The Obesity Health Alliance said the measures weren't ambitious and had let down the next generation who will pay the price for the government's failure to take strong action.

The alliance – which is a coalition of 33 national charities, medical royal colleges, and

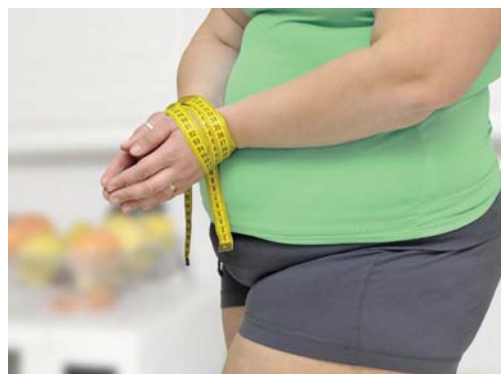

Today's obese children will be tomorrow's obese adults

campaign groups – said: "The government's plan is underwhelming and a missed opportunity to tackle the obesity crisis and its devastating burden on the health of both society and the NHS."

"We live in an environment where children and their families are bombarded by junk food advertising and many everyday foods and drinks are stuffed full of fat and sugar. This is fuelling the huge numbers of children we are seeing who are overweight and obese."

Action on Sugar added that Prime Minister Theresa May had failed the nation with the release of such a weak "obesity strategy".

Details: [http://lei.sr?a=f5Z2y\\_O](http://lei.sr?a=f5Z2y_O)

## DLL in brand marketing push

Racquet and fitness club operator David Lloyd Leisure (DLL) is relaunching its brand – a strategic move which will be supported by a nationwide marketing push.

The group's integrated campaign, called *Come to Life*, will include the brand's first ever national TV advert and a major marketing effort involving social, interactive and digital channels as well as outdoor ads, door drops and in-club communications.

The TV ad focuses on the breadth of offering at DLL facilities, the company's inclusive family approach and the amenities available at its clubs – conveying the idea that DLL is the place for everyone, whether they are a two-year-old or an 80-year-old looking to get active.

The campaign follows a significant investment and expansion programme which has seen DLL invest £80m in refurbishing and developing 77 of its existing UK clubs. It has also opened four new clubs – in Newbury, Glasgow, Antwerp in Belgium and Colchester.

Speaking to *Leisure Opportunities*, DLL chief executive Glenn Earlam said the campaign is



CEO Glenn Earlam wants to improve brand awareness in DLL

part of a strategy to strengthen awareness of the company's offering.

"There are too many people in our target market who don't know who we are or what we do," Earlam said. "In research we conducted, there was only a 59 per cent prompted brand awareness. We're good at sales – at impressing people with our facilities and converting them into members if they visit – but we're not very good at getting them there in the first place."

Details: [http://lei.sr?a=2b2b7\\_O](http://lei.sr?a=2b2b7_O)



# NEW EDUCATION & NEW LEARNING



**LEISURE  
INDUSTRY  
WEEK** NEC Birmingham UK

20th-21st September 2016

## SPEAKERS INCLUDE:



**NICK EASTWOOD**  
Deputy Chairman

Increase your profitability!  
Maximising leisure facilities  
and building a brand: the  
Wasps story.



**DR MIKE BRANNAN**  
Deputy National Lead

Strategic plan for the next  
four years: better outcomes  
by 2020.



**RAJA SAGGI**  
Head of B2B Marketing

Optimise your mobile  
marketing for maximum  
return.



**Save £299**  
Register for your  
**FREE** ticket  
before 1st August  
**WWW.LIW.CO.UK**

**FOR MORE INFORMATION VISIT: [WWW.LIW.CO.UK](http://WWW.LIW.CO.UK)**



**FITNESS**  
EDUCATION STREAM



**HEALTH**  
EDUCATION STREAM



**PLAY**  
EDUCATION STREAM



**SPORTS**  
EDUCATION STREAM



**FACILITIES  
MANAGEMENT**  
EDUCATION STREAM



**SPA &  
WET LEISURE**  
EDUCATION STREAM

### Cardiff centre reopens following £6.5m facelift

A Cardiff leisure centre has reopened after two-and-a-half years and £6.5m worth of refurbishment works.

Active Eastern, which is in the district of Llanrumney, reacquainted itself with the public on Saturday 20 August after closing in February 2014 to be refurbished.

The facility, which used to be called Eastern Leisure Centre, has dedicated spin class spaces, a five-lane swimming pool and a café. The fitness zone is one of the largest and best-equipped in the city, according to City of Cardiff Council, which runs the centre.

The centre attracts around 250,000 leisure users every year.

Details: [http://lei.sr?a=z7g7Y\\_O](http://lei.sr?a=z7g7Y_O)

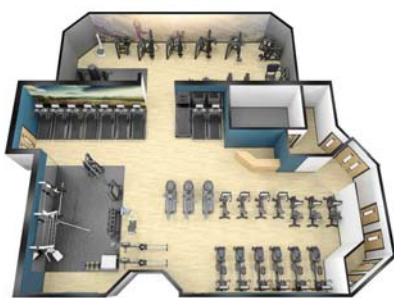

The fitness suite will boast 60 stations of CV kit

### Pulse to oversee Worthing Leisure Centre revamp

Leisure solutions provider Pulse Fitness has been selected to refurbish Worthing Leisure Centre and create a modern gym kitted out with the latest technology.

South Downs Leisure Trust, which manages Worthing Leisure Centre in West Sussex, has worked with Pulse for the past 15 years on a number of projects.

The equipment provider will be up-dating the gym, with a fitness suite that will boast 60 stations of Pulse's Series 3 cardio equipment. It will also install a Titan functional training rig. The refurbishment is valued at approximately £150,000.

All equipment will be fitted with Pulse's member management software – PulseMove – to help retention and grow membership by 25 per cent. The software comprises an in-gym kiosk, website and mobile app, which allows member data to be collected both in and outside the gym.

As part of the contract Pulse has provided a five-year warranty, full training for gym staff on all products to ensure they're able to help members get the most out of the new kit, and a marketing support package.

Details: [http://lei.sr?a=2h3w9\\_O](http://lei.sr?a=2h3w9_O)

## Revenue boost for The Gym Group

Growth in membership helped revenue at The Gym Group rise to £36.1m in the first six months of 2016, from £28.9m in the same period in 2015, representing a year-on-year increase of 25.1 per cent.

In its interim report for the half year to 30 June, results showed that pre-tax profits stood at £3.4m, against a £3.3m loss over the same period in 2015.

The increase in revenue was mainly due to the 22.8 per cent growth of members in the half-year period to 420,000, from 342,000 in the same period in 2015. Average revenue per member, per month, has increased by 1.6 per cent to £14.31, from £14.08 last year.

The Gym Group has 80 sites nationwide, with six gyms opening so far this year and more scheduled before the end of the year to meet the 2016 target of 15-20.

With 450 low-cost gyms in the UK, the business believes there is substantial opportunity for growth in the market.



CEO and founder John Trehan said progress had been made in 2016

The company expects to rollout out more gyms at an overall cost of between £1.3m and £1.4m per site. The interim report said: "We have substantial firepower from which to fund and develop the business, with a total of £40m of available financing facilities."

John Trehan, The Gym Group CEO, said: "Our rollout is on track with six sites opened in H1. We remain on target for 15-20 for the year and have a strong pipeline for 2017."

Details: [http://lei.sr?a=8Q5W9\\_O](http://lei.sr?a=8Q5W9_O)

## Fitness4Less launches Apex sessions

Budget health and fitness club operator Fitness4Less is introducing four Apex gym floor sessions into 12 of its sites.

The Apex programme, which is provided by the Physical Company, is a series of 30-minute 'ready-made' gym floor group training solutions. The sessions encourage members to make the most of gym facilities and innovative kit on the gym floor. Fifty members of staff across the 12 locations and two Topnotch Health Clubs in the group have completed the training, and the clubs will be rolling out Ignite, Agility, Strength and Core sessions. Sessions will be delivered by gym instructors and personal trainers to ensure a high level of interaction in groups of up to 12.

The four APEX programmes offer different types of workouts: Strength is for people who want to get stronger; Ignite is designed to get members leaner, fitter and faster; Core helps strengthen and protect the spine and improve core strength, posture, balance and stability; Agility helps people 'train like an athlete'.



Sessions will be delivered by gym instructors and personal trainers

Agility is the favourite session for Apex ambassador Dame Kelly Holmes. The 2004 double Olympic gold medal winner said: "Apex gives people the opportunity to work in a group environment with a range of different exercises and a variety of equipment. It's impressive how the instructors get really involved in the sessions and give teaching points: it feels like a personal training master class."

Details: [http://lei.sr?a=h6u8z\\_O](http://lei.sr?a=h6u8z_O)





# THE MATRIX | INTERNATIONAL SHOW 2016

Thu 13 - Fri 14 OCT 2016 / Ricoh Arena Coventry

*An unforgettable  
experience that  
reflects the future  
of the fitness  
industry and  
beyond*

**The Matrix International Show  
returns on October 13 & 14, 2016.**

Showcasing our vast range of new and existing Matrix products, the MIS promises to challenge the expected and deliver the unexpected, whilst welcoming international guests and hosting a unique networking opportunity.

Look out for news and announcements on Facebook and Twitter as more details are revealed.

Scan the code now to book your place for free entry to this exclusive event and register to receive the latest updates.



Scan now to register  
for MIS 2016

Supported by:



**[www.matrixfitness.co.uk](http://www.matrixfitness.co.uk)**

### MPs urge government to ban microbeads in products

Cosmetic companies should be banned from using plastic microbeads in products like exfoliating scrubs and toothpaste because of the marine pollution they are causing, the UK's cross-party Environmental Audit Committee is urging.

"Trillions of tiny pieces of plastic are accumulating in the world's oceans, lakes and estuaries, harming marine life and entering the food chain," said Environmental Audit Committee chair Mary Creagh. "The microbeads in scrubs, shower gels and toothpastes are a part of this plastic pollution problem."

It is estimated that 86 tonnes of microplastics are released into the environment every year in the UK from facial exfoliants alone. Details: [http://lei.sr?a=c4F7Y\\_O](http://lei.sr?a=c4F7Y_O)



The spa features a walled garden with hot tub

### Farm life and luxury spa combined in Kent

A farm estate in the English countryside has opened a new purpose-built spa on its grounds with a focus on combining wellness and the natural environment.

Green Farm near Ashford in Kent is located in a conservation area and surrounded by 12,500 acres of ancient woodland and traditional pastures, but located just 37 minutes from London by train.

The spa features two treatment rooms and offers exclusively ESPA massage, beauty and holistic therapies, and also features a walled garden for relaxation with hot tub, log-burning stove, outdoor shower and water feature, as well as a sauna.

"The essence is a boutique luxury spa, with a focus on the natural environment," said Maryann Richmond-Coggan, owner of Green Farm. "So in April, there are optional walks around the farm and lots of wood animals and lambs in the fields."

"In May time, evening hot tub listening to the nightingales and optional walks through the bluebells."

Details: [http://lei.sr?a=4V6P5\\_O](http://lei.sr?a=4V6P5_O)

## Spas invest in visiting practitioners

A growing number of spas are realising the importance of using visiting practitioners (VPs) to differentiate themselves and stand out in a crowded marketplace.

Visiting practitioner programmes – which can include everything from top yoga teachers and Roling experts to muay thai champions and spiritual shamans – can also boost a spa's profits, with some spas reporting a jump of up to 40 per cent.

"The programme is an additional revenue, and we can see an increase in profits, room nights and food and beverage during the months we host a popular VP," said Carina Lipold, wellness project director for resort and spa brand Six Senses.

Six Senses has had a VP programme since its inception in 1995 and has around 100 experts in its database. It charges between US\$150 (€133, £106) and US\$250 (€222, £176) for a one-hour session, and splits the revenue 50/50 with the VP.

But not all VP programmes need to be so extensive to be successful; wellness



Six Senses currently has around 100 active experts on its database

destination Como Shambhala has had a VP programme since 2000, and has around eight active practitioners, with energy workers and Roling experts particularly popular.

And there is an added benefit: "Many of our visiting experts have their own loyal followers or 'tribes' who seek them out and then book stays at our wellness retreats, resorts and hotels," said Monica Barter, group operations director for Como Shambhala.

Barter said the programme is worth up to 30 per cent of the company's annual revenue. Details: [http://lei.sr?a=y9m3m\\_O](http://lei.sr?a=y9m3m_O)

## DLL and Elemis strike beauty deal

Members at David Lloyd Leisure's health and racquet clubs will be treated to luxury face and body products after the operator tied up a deal with British skincare and spa brand Elemis.

Locker rooms at its 82 clubs will begin offering complimentary Elemis hand wash and body lotion.

Products will also be available at the club's four Amida spas in Beckenham, Chelsea, Farnham and Hampton.

Noella Gabriel, Elemis Therapies co-founder and creator, said: "We are thrilled to be entering David Lloyd clubs and its Amida spas this month. It is the perfect relationship with Elemis and David Lloyd Leisure, both representing the very best of British within the health and beauty industries."

Paul Batty, head of procurement at David Lloyd Leisure, said: "David Lloyd Leisure is excited to welcome Elemis into all of our UK clubs. There is a clear strong synergy between



David Lloyd's Club Amida spas will have a range of Elemis products

the two brands through the product offering, service and customer care. David Lloyd members can now feel that extra little bit more pampered on each visit to their club."

David Lloyd Leisure relaunched its brand last month, following a significant investment and expansion programme which has seen DLL invest £80m in its existing UK clubs.

Details: [http://lei.sr?a=6X7W4\\_O](http://lei.sr?a=6X7W4_O)





# BARR + WRAY

CREATORS OF WELLBEING AND RELAXATION

Interior Design | Engineering Design | Pool + Thermal Installation | Maintenance



UK + Europe  
Barr + Wray  
T: + 44 141 882 9991  
E: sales@barrandwray.com



Middle East + Asia  
Barr + Wray Dubai  
T: + 971 4320 6440  
E: sales@barrandwray.com

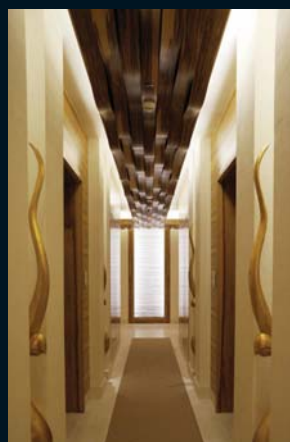

Asia Pacific  
Barr + Wray Hong Kong  
T: + 852 2214 9990  
E: sales@barrandwray.com

[www.barrandwray.com](http://www.barrandwray.com)

NEW BRAND | NEW DATE | NEW VENUE

Following the acquisition of Hotel Designs, the formerly known Hotel Summit has been rebranded to stay current within an ever changing and evolving industry.

With the perfect mix of business meetings, networking and educational seminars the Hotel Designs Summit ensures your time is well spent.



HOTELDESIGNS  
**SUMMIT**  
Interiors • Structures • Solutions

For more information, please contact  
Jade Oliver on 01992 374054 or email  
[j.oliver@forumevents.co.uk](mailto:j.oliver@forumevents.co.uk)

**12th & 13th September 2016**  
**Radisson Blu Hotel, London Stansted**



[forumevents.co.uk](http://forumevents.co.uk)



[@hoteldesigns](https://twitter.com/hoteldesigns) #HDSummit



[hoteldesigns.net](http://hoteldesigns.net)



[hoteldesigns](https://www.instagram.com/hoteldesigns)

**MEDIA & INDUSTRY PARTNERS:**



HOTELDESIGNS

[www.leisureopportunities.co.uk](http://www.leisureopportunities.co.uk)  
**leisureopportunities**

**ORGANISED BY:**





## De Niro's London hotel approved

Hollywood star Robert De Niro has been given the go ahead to build his planned luxury hotel in London's Covent Garden after the deputy leader of the local council hailed the design as "one of the finest schemes we have considered in years."

Planning permission for The Wellington Hotel has now been granted, enabling the star of *Taxi Driver* and *Raging Bull* to increase his burgeoning hospitality portfolio.

Architects Kohn Pedersen Fox have designed the 83-room hotel, which will be housed in six adjacent buildings, three of which are Grade II listed. Substantial renovation, including the creation of new storeys, will take place to the interiors of three of the buildings, but the historic facades will be retained.

Speaking about the plans in May, De Niro – who has partnered with development firm Capital & Counties Properties and hospitality operator BD Hotels – said: "London is one of the most exciting and cosmopolitan cities in



The Hollywood star's London hotel is scheduled to open in 2019

the world, so it makes perfect sense to develop a hotel that represents all of that in the heart of this city in Covent Garden."

The hotel will have 83 guest rooms, a spa, two restaurants, a café, a private members' club and a roof garden on the top of one of the buildings on Wellington Street. Construction will begin next year with an opening planned for 2019.

Details: [http://lei.sr?a=a3K9G\\_O](http://lei.sr?a=a3K9G_O)

## 'Hotel train' launched in Ireland

Hotel, train and river-cruise operator Belmond launched "Ireland's first luxury rail experience" on 30 August, with 10 sleeper carriages designed by James Park Associates to evoke Dublin's Georgian architecture.

The Belmond Grand Hibernian – which can carry up to 40 passengers in 20 en-suite cabins – will transport guests on three-day journeys across the Republic of Ireland and Northern Ireland, stopping in Dublin, Belfast and Cork.

Belmond purchased the 10 carriages and locomotive from Irish Rail earlier this year. The carriages were painted with a midnight blue and silver livery in Kilmarnock, Scotland, before being transported back across the Irish Sea for this next stage in development. A team of 40 craftsmen from specialist outfitters Mivan Marine Ltd in Belfast have built the interior cabins, as well as two dining cars and an observation carriage. All interior furnishings are supplied by local businesses, including hand-crafted stone counters.



Belmond operates luxury trains and cruise ships around the world

James Park's design elements are inspired by Ireland's ancient folklore and traditions, and the flora and fauna passengers will see in the passing landscape.

"It's very important to Belmond that we work with local experts and craftsmen to create a truly authentic train that reflects the spirit of the countries through which it will travel," said Belmond MD Gary Franklin.

Details: [http://lei.sr?a=M9v9r\\_O](http://lei.sr?a=M9v9r_O)

## Brexit's silver lining



**PETER DUCKER**  
is chief executive  
of the Institute  
of Hospitality

The government's Tourism Action Plan, published last month (August) contains some remarkable statistics. We already knew that 2015 was a record-breaking year for inbound tourism, but what is astonishing is that 2016 looks set to be even better. In the six months to June 2016 there were 17.3 million international visits to the UK, a 2.2 per cent increase on the same period a year earlier, with strong rises in visits from Europe and North America.

Of course this data refers to the period before Britain voted to leave the EU. The consequent fall in the value of the pound looks set to bring even more international tourists to our shores. For American visitors to the UK, prices are now 30 per cent lower than two years ago. In the month after the June EU referendum, Cheapflights, a price comparison website, reported a 33 per cent rise in searches for flights into the UK from Canada and a 20 per cent jump for flights from the US. A Tourism Alliance survey of businesses that cater for overseas visitors showed that nearly a fifth reported a rise in forward bookings during July.

American tourists have always been our biggest spenders. Now that they will be arriving in greater numbers, there is no better time to fine-tune our customer service skills in order to wow guests and keep them coming back. The Institute of Hospitality is delighted to kick-start its autumn webinar season on 6 September with Simon Hudson, a hospitality expert from the University of South Carolina, who will deliver his unique insights into what US tourists are looking for.

As Prime Minister Theresa May announces a £33m commitment to fight the 'barbaric evil' of modern slavery, another webinar in our new series highlights how hotels regrettably and often unwittingly provide a safe haven for human traffickers and their victims. The webinar presents exclusive primary research and explains what hospitality employees can do to prevent, mitigate and eliminate the risk of modern slavery (or human trafficking) taking place in their businesses.

## Cyborgs and art included on MuseumNext agenda

American Museum of Natural History president Ellen Futter and Cyborg Foundation co-founder Neil Harbisson are among the names scheduled to speak at the global MuseumNext conference in New York.

Starting on Monday 14 November, the two-day conference, which looks at the future of museums, will open with a roundtable session addressing changes in audiences, shifting storylines, and the need for "next narratives".

Tony Butler, executive director of Derby Museums Trust will conclude the second day's talks, before an evening event to wrap up the conference.

Details: [http://lei.sr?a=D5m3g\\_O](http://lei.sr?a=D5m3g_O)

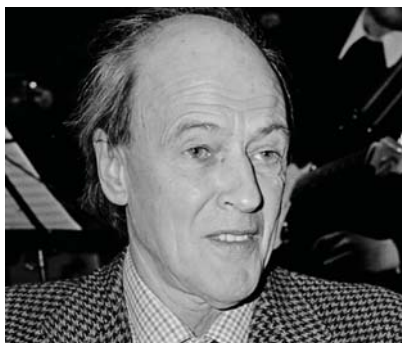

Writer Roald Dahl died in 1990, aged 74 years

## Roald Dahl exhibition opens in Wales

The Wales Millennium Centre has opened its largest exhibition yet, celebrating the life and works of the much-loved children's author, Llandaff-born Roald Dahl.

The Wondercrump World of Roald Dahl, which moved to Welsh capital following its stint at London's Southbank Centre, coincides with what would have been the writer's 100th birthday on 13 September.

The exhibition features artefacts, letters and manuscripts from the Roald Dahl Museum and Story Centre, as well as interactive and "magical" elements which illustrate the many sides of the remarkable man, who recorded his experiences as a schoolboy and as a WWII fighter in the memoirs *Boy* and *Going Solo*.

"It's fantastic to be able to celebrate the world's greatest storyteller with The Wondercrump World of Roald Dahl in Cardiff, the city of his birth," said Steve Gardam, director at the Roald Dahl Museum and Story Centre.

"This will inspire hundreds of young minds to go on to create worlds of their own."

Details: [http://lei.sr?a=x8Y7j\\_O](http://lei.sr?a=x8Y7j_O)

## Jim Clark museum plans filed

A museum celebrating the successes of racing driver Jim Clark is on the cards after plans were unveiled by the Scottish Borders Council to celebrate the life of the two-time Formula One champion.

To be financed in-part by the Heritage Lottery Fund (HLF) pending approval, the £1.65m (US\$2.2m, €1.9m) project would see the existing Jim Clark Room in Duns expanded and redeveloped to allow a selection of cars and trophies to go on display.

Plans for the development were lodged in August, but the museum's programming is being left to public opinion.

An online survey by the Scottish Borders local government is asking how interested visitors would be in Clark's upbringing, personality, rise to the world title, the teamwork behind his success, racing cars, the development of motor racing as a sport, and Clark's overall influence and legacy.

"It is envisaged that the redeveloped museum will attract tourists and motor racing enthusiasts alike, thus contributing to the local



Clark won the Formula One world championship in 1963 and 1965

economy and the Scottish Borders generally," said a design statement submitted with the plans. "The proposed alterations respect the original design of the building, whilst also addressing issues with the condition of its fabric, by creating a contemporary, visitor attraction for the 21st century."

If plans are approved and HLF funding is granted, it is hoped the development will be completed by 2018 in time to commemorate the 50th anniversary of Clark's death at the Hockenheimring in Germany.

Details: [http://lei.sr?a=P7d5P\\_O](http://lei.sr?a=P7d5P_O)

## BP sponsorship 'poses questions'

Oil giant BP's sponsorship of cultural attractions in the UK has not breached the Museum Association's (MA) code of ethics – although it has raised significant questions around sponsorship arrangements in general, said the body. The MA's judgement refers to a report published by lobby group Art Not Oil, which alleged BP had a "corrupting influence" over the institutions it sponsors.

Published last May, the in-depth report drew on hundreds of emails, documents and correspondence released through the Freedom of Information Act, revealing alleged interference in curatorial decision-making and museum security from BP at national institutions such as the British Museum, National Portrait Gallery, Tate and Science Museum.

After studying the report, the MA's ethics committee ruled that the evidence outlined had not broken its code of ethics, with the body emphasising that its remit during the investigation was to consider the relationship



The ethics surrounding BP's sponsorship has been questioned

between a museum and a sponsor rather than commenting on the global practices of BP.

In regards to allegations of BP having undue influence on curatorial decision-making, the committee said that it recommends against seeking direct approval on acquisitions or exhibition content, as it may "give the appearance of undue sponsor influence".

Details: [http://lei.sr?a=w4U6Q\\_O](http://lei.sr?a=w4U6Q_O)





# VAC2016



**6 October 2016**

*Put it in your diary now!*



## **THE ANNUAL NATIONAL CONFERENCE OF VISITOR ATTRACTIONS**

**Thursday 6 October - The QEII Conference Centre, London.**

The essential event for owners, managers and marketers of a visitor attraction, for opinion formers and tourism or heritage professionals.

VAC is a national conference organised by the industry, for the industry where you can:

- Get involved in a unique forum for industry professionals.
- Network and share experiences.

Don't miss this opportunity to:

- Understand your business in the context of the wider visitor attractions market.
- Keep up to date and find new directions for your business.

**Join our mailing list to receive regular conference updates.**  
**Early bird and multiple booking discount registration rates apply.**

[www.vacevents.com](http://www.vacevents.com)

**Principal Sponsor:**



**BURGESS  
SALMON**

**Official Publication:**

**Attractions**  
MANAGEMENT

**Supported by:**



**ALVA**  
Association of Leading  
Visitor Attractions

## Boosting rural tourism



**KURT JANSON**  
is director of the  
Tourism Alliance

Rural tourism is a significant component of the UK tourism industry. In 2015, 20m overnight trips were taken to rural destinations while day-visitors undertook a further 335m trips. Together, these visitors spent £20.7bn, sufficient to support 380,000 jobs.

The value of tourism to the rural economy, combined with decreasing revenue for farming operations, has prompted the Environment, Food and Rural Affairs Select Committee to hold an inquiry to determine what more can be done to help farmers diversify and boost the sector.

While there are a number of factors such as regulations and funding that could be addressed to allow rural businesses to better compete with urban and overseas destinations, there are two primary issues that need to be tackled – planning and broadband.

One of the main barriers to tourism growth in rural areas is the current planning framework which does not provide sufficient guidance. To grow, rural tourism requires both the maintenance of the natural and historic landscape and the ability for businesses to develop and expand. Because these requirements can be contrary, there needs to be strong guidance in place.

However, when the new National Planning Policy Framework was developed, the detailed tourism guidance was replaced by a guidance that relates only to developments in town centres. The resultant vacuum has added uncertainty, increasing costs and delays as applications get bogged down in the appeals process.

The second main barrier to rural tourism growth continues to be the availability and quality of broadband services. While 10Mbps is sufficient to meet the needs of most SMEs, a study of tourism businesses in the New Forest found that only 8 per cent of businesses received this. A similar survey of tourism businesses in Cornwall found that 55 per cent had speeds of less than 10Mbps.

So, while a lot could be done to reduce regulation and improve promotional and developmental funding for rural businesses, the core issues of being able to locate a business and to let the world know that you are there need to be addressed first.

## TOURISM

# Government eyes Brexit boost

The UK government is capitalising on a weakened pound by unveiling a series of measures designed to boost the domestic tourism sector.

Dubbed the *Tourism Action Plan*, the new initiatives have been planned to make Britain the choice destination for inbound tourists, welcoming more international visitors than ever before and increasing the number of “staycations” as Brits opt to holiday on home soil.

To make it easier for people wanting to explore the UK, the government will implement a new GREAT tourism rail offer, with a series of single-booking itineraries encouraging travel around the country.

For seasonal workers, such as those working in the hospitality sector, a flexible apprentice scheme will allow businesses to train staff over a period of 18 months rather than 12 months. To help bed and breakfast offerings, the government is planning to introduce regulatory changes to allow the accommodation providers to serve alcohol. It is also modifying vehicle licensing to allow B&B owners to pick visitors up from stations.



The plan will look to draw tourists to locations outside of London

The *Tourism Action Plan* is supported by a £10.2m funding partnership between VisitBritain and Expedia, which will be used to advertise Britain to several key markets including the US, Germany and France.

In an attempt to draw international visitors to parts of the UK outside of London, the government has announced that projects in alternative regions will get part of its £40m Discover England fund – a lifeline the Tourism Alliance said last year would help create thousands of jobs.

Details: [http://lei.sr?a=4P9Z2\\_O](http://lei.sr?a=4P9Z2_O)

## Scots coastal tourism worth £323m

Scotland's coastline has become a major tourism revenue generator and its worth to the Scottish economy is now estimated at £323m.

The figure comes from a new VisitScotland insight paper, titled *Coastal Tourism in Scotland* which was published last month.

The report shows that there has been a steady increase in domestic tourism at Scottish seaside locations since 2010.

Between 2010 and 2014, domestic trips increased by 6 per cent to an average of 1.5 million trips, while spend went up 9 per cent to £323m.

According to the report, the west of Scotland attracts the largest number of domestic visitors, with an average of 612,000 trips a year, generating £112m in spend.

Malcolm Roughead, CEO of VisitScotland, said: “Scotland boasts an incredible coastline with some of the finest beaches in the world, with seaside breaks playing a vital role in



Domestic trips increased by 6 per cent between 2010 and 2014

the country's visitor economy. Our *Coastal Tourism in Scotland* paper gives a fascinating insight into who visits our beaches, and why. It is no surprise that the beautiful and mysterious Sandwood Bay captures the imagination of so many people around Britain, but its majesty can only be truly appreciated at first hand.”

Details: [http://lei.sr?a=w4g4X\\_O](http://lei.sr?a=w4g4X_O)





**Are you thinking of buying, selling, reviewing or leasing health & fitness sites in 2016?**

**CONTACT THE PROFESSIONALS:**

Lyndon Yeomans Property Consultants LLP  
11 Savile Row, London W1S 3PG  
Tel: 020 7437 9333

[www.lydonyeomans.co.uk](http://www.lydonyeomans.co.uk)

## RETAIL AND LEISURE EXPERTS

INDEPENDENT NO NONSENSE ADVICE

**WILD**

COMMERCIAL PROPERTY

01244 321 555

[www.wildcp.co.uk](http://www.wildcp.co.uk)

Isle of Wight  
property experts  
covering all  
sectors of the  
leisure industry.

**Hose  
Rhodes  
Dickson**

**CONTACT: 01983 527727**

Nick Callaghan, Lisa Mercer or Janet Morter

[www.hose-rhodes-dickson.co.uk](http://www.hose-rhodes-dickson.co.uk)

## TO ADVERTISE IN THE PROPERTY DIRECTORY

please contact  
Simon Hinksman on  
**(01462) 471905**

or email  
[property@leisuremedia.com](mailto:property@leisuremedia.com)

## LEISURE PROPERTY FORUM CORPORATE MEMBERS' DIRECTORY



For membership information  
please contact Michael Emmerson  
[info@leisurepropertyforum.org](mailto:info@leisurepropertyforum.org)

[www.leisurepropertyforum.org](http://www.leisurepropertyforum.org)

**3DReid Ltd**  
Tel: 0121 212 2221  
[www.3dreid.com](http://www.3dreid.com)

**Alan Conisbee & Associates Ltd**  
Tel: 020 7700 6666  
[www.conisbee.co.uk](http://www.conisbee.co.uk)

**Angermann Goddard & Loyd**  
Tel: 020 7409 7303

**Ashurst LLP**  
Tel: 020 7638 1111  
[www.ashurst.com](http://www.ashurst.com)

**Barclays Bank Plc**  
Tel: 07920 267452

**Bilfinger GVA**  
Tel: 0207 911 2228  
[www.gva.co.uk](http://www.gva.co.uk)

**BNP Paribas Real Estate UK**  
Tel: 0207 484 8132

**Brook Street des Roches LLP**  
Tel: 01235 836614  
[www.bsdr.com](http://www.bsdr.com)

**Burges Salmon LLP**  
Tel: 0117 902 6681

**Burrows Little**  
Tel: 020 77249783  
[www.burrowslittle.com](http://www.burrowslittle.com)

**CallisonRTKL UK Ltd**  
Tel: 020 7306 0404  
[www.rtkl.com](http://www.rtkl.com)

**Canadian & Portland Estate Plc**  
Tel: 07990 033337

**CBRE Ltd**  
Tel: 020 7182 2197  
[www.cbre.com](http://www.cbre.com)

**Chesterton Humberts**  
Tel: 020 3040 8240

**Christie & Co**  
Tel: 0113 389 2700  
[www.christiecorporate.com](http://www.christiecorporate.com)

**Citygrove Securities Plc**  
Tel: 020 7647 1700  
[www.citygrove.com](http://www.citygrove.com)

**CMS Cameron McKenna LLP**  
Tel: 020 7367 2195  
[www.cms-cmck.com](http://www.cms-cmck.com)

**Colliers International  
Property Consultants Ltd**  
Tel: 020 7487 1710  
[www.colliers.com/uk](http://www.colliers.com/uk)

**Cushman & Wakefield LLP**  
Tel: 0207 152 5278  
[www.cushwake.com](http://www.cushwake.com)

**Davis Coffer Lyons**  
Tel: 020 7299 0700  
[www.coffergroup.co.uk](http://www.coffergroup.co.uk)

**DKAhp**  
Tel: 020 7637 7298  
[www.dkahp.com](http://www.dkahp.com)

**FaulknerBrowns Architects**  
Tel: 0191 256 1548  
[www.faulknerbrowns.co.uk](http://www.faulknerbrowns.co.uk)

**Fieldfisher**  
Tel: 020 7861 4171

**Fladgate LLP**  
Tel: 020 3036 7000  
[www.fladgate.com](http://www.fladgate.com)

**Fleurets Limited**  
Tel: 020 7280 4700  
[www.fleurets.com](http://www.fleurets.com)

**Forsters LLP**  
Tel: 020 7863 8333  
[www.forsters.co.uk](http://www.forsters.co.uk)

**Freeths LLP**  
Tel: 0845 271 6775  
[www.kimbellsfreeth.com/hospitality](http://www.kimbellsfreeth.com/hospitality)

**Gala Leisure Limited**  
Tel: 0208 507 5445  
[www.galacoral.com](http://www.galacoral.com)

**Gerald Eve LLP**  
Tel: 020 7333 6374  
[www.geraldev.com](http://www.geraldev.com)

**Go Jumpin Ltd**  
Tel: 07985 523 650

**Gowling WLG (UK) LLP**  
Tel: 0121 393 0810

**Holder Mathias**  
Tel: 0207870735

**Howard Kennedy LLP**  
Tel: 020 3755 5507  
[www.howardkenedy.com](http://www.howardkenedy.com)

**Indigo Planning**  
Tel: 020 8605 9400  
[www.indigoplanning.com](http://www.indigoplanning.com)

**James A Baker**  
Tel: 01225 789343

**John Gaunt & Partners**  
**Jones Lang Lasalle**  
Tel: 020 7493 6040  
[www.joneslanglasalle.co.uk](http://www.joneslanglasalle.co.uk)

**Knight Frank LLP**  
Tel: 020 7861 1525

**Lambert Smith Hampton**  
Tel: 0207 955 8454  
[www.lsh.co.uk](http://www.lsh.co.uk)

**Land Securities Properties Ltd**  
Tel: 020 7747 2398  
[www.x-leisure.co.uk](http://www.x-leisure.co.uk)

**LaSalle Investment Management**  
Tel: 0207 852 4562  
**Legal & General Investment  
Management Holdings Ltd**  
Tel: 020 3124 2763  
[www.lgim.co.uk](http://www.lgim.co.uk)

**Lunson Mitchenall**  
[www.lunson-mitchenall.co.uk](http://www.lunson-mitchenall.co.uk)

**Matthews & Goodman**  
Tel: 020 7747 3157  
[www.matthews-goodman.co.uk](http://www.matthews-goodman.co.uk)

**Memery Crystal LLP**  
Tel: 020 7242 5905

**Merlin Entertainment  
Group Ltd**  
Tel: 01202 493018  
[www.merlinentertainments.biz](http://www.merlinentertainments.biz)

**MLM Consulting Engineers**  
**Montagu Evans LLP**  
Tel: 0207 493 4002

**Morgan Williams**  
**MSG Corporate**

**Odeon & UCI Cinemas Ltd**  
Tel: 0161 455 4000  
[www.odeonuk.com](http://www.odeonuk.com)

**Olswang**  
Tel: 020 7067 3000  
[www.olswang.com](http://www.olswang.com)

**Pinders**  
Tel: 01908 350500  
[www.pinders.co.uk](http://www.pinders.co.uk)

**Rank Group Plc**  
Tel: 01628 504000  
[www.rank.com](http://www.rank.com)

**Roberts Limbrick Ltd**  
Tel: 03333 405500  
[www.robertslimbrick.com](http://www.robertslimbrick.com)

**RPS CgMs**  
Tel: 0207583 6767

**Savills (UK) Ltd**  
[www.savills.com](http://www.savills.com)

**Shelley Sandzer**  
[www.shelleysandzer.co.uk](http://www.shelleysandzer.co.uk)

**The Leisure Database  
Company**  
Tel: +44 (0)20 3585 1441  
[www.leisuredb.com](http://www.leisuredb.com)

**TLT LLP**  
Tel: 0117 917 7777  
[www.ttlsolicitors.com](http://www.ttlsolicitors.com)

**Tragus Group**  
Tel: 020 7121 6432  
[www.tragusgroup.com](http://www.tragusgroup.com)

**Trowers & Hamlin LLP**  
Tel: 020 7423 8084  
[www.trowers.com](http://www.trowers.com)

**Wagamama Ltd**  
Tel: 0207 009 3620  
[www.wagamama.com](http://www.wagamama.com)

**Willmott Dixon  
Construction Ltd**  
Tel: 01932 584700  
[www.willmotttdixon.co.uk](http://www.willmotttdixon.co.uk)

Plus there are more than 70 other companies represented by individuals.



The design will convey the story of Eneko Atxa

## 'Storytelling design' for London restaurant

Exhibition designers Casson Mann have designed a colourful story-filled restaurant for five-star London hotel One Aldwych.

The restaurant, called Eneko, opened on 1 September in the hotel's basement.

Museum interior specialists Casson Mann were selected to work on the project – their first restaurant design – because of their storytelling expertise. The brief called for the design to convey the story of its Michelin starred chef, Eneko Atxa, and his Basque heritage.

"All our museum experience is about transforming stories into engaging spatial experiences," said studio founder and director Roger Mann. "This has been a similar challenge, albeit with a shift from a direct to a subtle emphasis in the way we link narrative to materials and invite emotional and functional connections."

Details: [http://lei.sr?a=d6a5e\\_O](http://lei.sr?a=d6a5e_O)

## UNESCO to develop 'satellite visitor centres'

Two architecture studios hope to show how remote heritage sites can be served by 'satellite' visitor centres through their own design for a tourist hub which celebrates an uninhabited Scottish archipelago from a location on a nearby island.

Scottish studio Dualchas Architects and Norway's Reiulf Ramstad Architects, who are working in the UK for the first time, have unveiled their masterplan for the St Kilda Visitor Centre. They propose the building, known as Iomart Hiort in Gaelic, should be built on the more accessible Isle of Lewis 50 miles away.

St Kilda contains the westernmost islands of the Outer Hebrides of Scotland, on the far edge of Europe. Its dramatic geological formations have seen it being named a UNESCO World Heritage Site.

Details: [http://lei.sr?a=W6V9y\\_O](http://lei.sr?a=W6V9y_O)

## Bats threaten Chelsea FC plans

Chelsea FC's plans to build one of the largest stadiums in England have hit a stumbling block – a local population of endangered bats.

The club submitted its plans for the £500m (US\$660m, €584m) project to London's Hammersmith and Fulham council last year, but has been asked to provide more evidence of how it will protect the nearby grade I-listed Brompton cemetery and its population of nocturnal mammals. The council wants more detail about the impact of piling works on the cemetery's catacombs – identified as a hibernation roost for bats – and the effect caused by artificial lighting.

Designed by Swiss architects Herzog & de Meuron, the development would see the demolition of the club's existing 41,600-capacity Stamford Bridge ground and its surrounding buildings, and its replacement with a 60,000-capacity stadium.

The new development would include a club shop and museum, as well as a separate restaurant or café.



Work on the 60,000-capacity London stadium is likely to be delayed

The building of the project would require excavation works and the construction of external concourse areas.

The council has reportedly written to AECOM, strategic planner on the scheme, to seek more certainty over the proposed phasing of this process and any measures taken to mitigate noise, dust and road closures for local residents and businesses.

The club had previously explored the possibility of moving to Earls Court, White City or Battersea Power Station.

Details: [http://lei.sr?a=u4e4u\\_O](http://lei.sr?a=u4e4u_O)

## Heatherwick hits back on bridge plan

British designer Thomas Heatherwick has launched an impassioned defence of his Garden Bridge project in London, arguing that the project has been used as a political football by "people with an agenda" and those "who love to sneer."

The scheme – a 367m (1,200ft) planted River Thames crossing linking South Bank and Temple – has attracted controversy and negative headlines over the allegedly opaque procurement process and the public funding required to build it.

Heatherwick hit back at his critics on the BBC's *Newsnight* programme, stating that any rejection of the project at this stage would show that "we have suddenly become a society who have no confidence in ourselves".

"There's all sorts of people who want to get their little agenda and pin it onto this project," he said. "But it's a truly amazing project. How can it possibly be a bad thing to stitch



The 367m long plant-filled bridge is estimated to cost around £175m

the city together better, to create new public space that we have never had before, to create new views for all of us?"

*Newsnight* report uncovered a £22m funding gap that will raise more questions about who will shoulder the cost of the bridge. According to the BBC, private funders have withdrawn over the last year, and an estimated £30m shortfall is actually closer to £52m.

Details: [http://lei.sr?a=F8B9V\\_O](http://lei.sr?a=F8B9V_O)





## Join the LPF

MEMBERSHIP INCLUDES:

- Regular networking opportunities
- A full programme of leisure property related early evening seminars
- Details of forthcoming LPF events and other industry dates on our website
- Members' rates to LPF seminars and events
- Complimentary places at some events
- A free subscription to Leisure Opportunities magazine, which features regular LPF columns, tenders, for sale adverts and property news
- A 10% discount on property advertising in Leisure Opportunities magazine
- A dedicated LPF monthly email bulletin, delivered straight to your mailbox
- Access to the full listing of all our members

**FOR MORE INFORMATION CONTACT:**  
**Michael Emmerson, LPF Administration**  
**E: [info@leisurepropertyforum.org](mailto:info@leisurepropertyforum.org)**  
**T: 01462 471932 F: 01462 433909**  
**W: [www.leisurepropertyforum.org](http://www.leisurepropertyforum.org)**



## For Sale



### Major UK Visitor Attraction

- Strategically located
- Renowned DVA
- Fully capitalised
- Established profitability
- Large scale planning permissions granted

**Offers in the region of £7.5m**

For more information please contact:  
**Matthew Lamb**  
[Matthew.lamb@gva.co.uk](mailto:Matthew.lamb@gva.co.uk)

**[gva.co.uk/10063](http://gva.co.uk/10063)**  
**08449 02 03 04**



**Mole Valley District Council** is building a soft play and café facility at Meadowbank Park, near the heart of Dorking town centre in Surrey.

We are looking for expressions of interest from prospective tenants to lease the new soft play and café facility from August 2017 when the construction is due for completion.

The facility is part of a wider development that includes a new 3G football pitch, changing rooms, stands and club house. A new outdoor play area near the planned soft play and café facility has recently opened.

Visitors to Meadowbank can park at nearby St Martin's Walk public car park.



The café will serve visitors to both the soft play and the park and will benefit from an outside patio area overlooking the playground with a total seating area of ca. 108 sq. metres. The soft play floor to ceiling height will allow up to three storeys of play with potential for more with reduced head room, with a play equipment area of ca. 287sq. metres.

If you are interested in leasing the soft play and café facility from Mole Valley District Council, please get in touch using the details below.

**Sally Hewetson**

**T: 01306 870 619**

**E: [sally.hewetson@molevalley.gov.uk](mailto:sally.hewetson@molevalley.gov.uk)**

**W: [www.meadowbankdorking.co.uk](http://www.meadowbankdorking.co.uk)**



## Hit the Ground Running with an Active IQ Qualification

Discover the opportunities available to your learners when you become an Active IQ approved centre. We will ensure you are fully prepared to offer students everything they need to start their careers in the active leisure sector.



Connect with us  
in 

#activequalifications

Visit  
[www.activeiq.co.uk/join](http://www.activeiq.co.uk/join)  
to become approved and get your  
first 5 registrations free - quote  
'5REG15'

## TRAINING

# Future Fit signs Reebok deal

Health and fitness training provider Future Fit Training has teamed up with Reebok Archon so trainers and their clients can effectively measure, evaluate and improve their performance.

The Reebok Archon Platform uses a series of algorithms, which combine to standardise and regulate fitness testing and assessment, providing data across strength, power, agility, coordination and endurance.

By inputting an individual's scores set against their personal profile – including gender, age, weight and wingspan – Reebok Archon provides an accurate and real-time representation of someone's fitness.

Once a user has registered their details and created a personal profile at [archon.reebok.co.uk](http://archon.reebok.co.uk) they can choose from 12 optional assessments they wish to complete.

They then do the activity and upload their metrics. Immediately, they will be given a status of their assessment and progress. From here they can use educational content and videos to help them improve.



The deal will improve trainers' ability to measure and evaluate clients

Charts and tracked statistics give the user information about their progress. Users can share content with friends and on social media.

Future Fit Training, which educates fitness professionals, said that the platform is the perfect tool for its trainers and graduates, who will be able to register on the platform via a bespoke student zone.

They will also become Archon adjudicators, meaning they will be able to validate inputted scores and become fitness assessors.

Details: <http://lei.sr?a=eiEot>

# PHE recruits clinical champions

Public Health England (PHE) is recruiting more clinical champions as part of its drive to improve the health and wellbeing of people.

The role of a clinical champion is to recognise the potential of physical activity and incorporate it into patient care. PHE is looking for six clinical champions - two for London (nurse and midwife) and one each for the South East, South West, East Midlands and West Midlands (GPs).

PHE launched a national physical activity framework – Everybody Active, Every Day – in October 2014. The document showed that 45 per cent of women and 33 per cent of men are not active enough for good health, and that 26 per cent of women and 19 per cent of men are physically inactive.

The clinical champions programme provides peer-to-peer training with a specialist interest in physical activity through one-off education and development sessions. Following a successful pilot, PHE is extending the scheme. The aim of the programme is to educate



A third of men are not active enough for good health

clinicians around the areas of physical activity and its benefits, risks of inactivity, statistics regarding inactivity, exercise physiology in primary and secondary prevention, motivational interviewing and local provisions for physical activity.

In July, the Royal College of GPs announced that physical activity would be given greater prominence by local GP practices.

Details: [http://lei.sr?a=egG8P\\_O](http://lei.sr?a=egG8P_O)



**premier**  
TRAINING INTERNATIONAL

**TRUST THE  
TRAINING**

**EXPERTS\* TO DELIVER  
THE EXPERT TRAINING  
YOU NEED.**

Premier Training provides the expert training **YOU** need.

- Recruitment Solutions
- In house training
- Corporate rates
- NEW! Health and Wellbeing Qualification

\* The Premier Training International Industry Survey was conducted between August and September 2014, involving over 400 Employers, Personal Trainers and Personal Trainer Students.

**CONTACT US NOW**  
**EMAIL:** [corporate@premierglobal.co.uk](mailto:corporate@premierglobal.co.uk)  
**OR CALL:** 03333 212 092  
**[www.premierglobal.co.uk](http://www.premierglobal.co.uk)**

**#FITFORYOU**

**active IQ**

**Hit the Ground  
Running with an  
Active IQ Qualification**

Discover the opportunities available to your students when you become an Active IQ approved centre. We will ensure you are fully prepared to offer students everything they need to start their careers in the active leisure sector.

**Introducing our  
PROFESSIONAL  
RECOGNITION  
SERVICE**  
Gain our quality kite mark on your CPD courses.

**Connect with us**  
**in**   
**#activequalifications**

Visit **[www.activeiq.co.uk/join](http://www.activeiq.co.uk/join)**  
to become approved and get your first 5 registrations free - quote '5REG15'

## TRAINING & EDUCATION DIRECTORY

For more details on the following courses visit [www.leisureopportunities.co.uk](http://www.leisureopportunities.co.uk)



**lifetime**  
the future feels good

**Company: Lifetime**  
**Location: Nationwide, UK**

- Personal Training Diploma
- Lifetime PTA Global Maxima
- Personal Training Diploma

**focus**  
training

**Company: Focus Training**  
**Location: Nationwide, UK**

- Become a Personal Trainer
- GP Exercise Referral
- Exercise to Music Instructor
- Become a Gym Instructor

**ORIGYM**  
CENTRE OF EXCELLENCE

**Company: Origym**  
**Location: Nationwide, UK**

- Online Personal Training course

**YMCA**  
fit

**Company: YMCA Fitness**  
**Location: Nationwide, UK**

- Specialise with our GP Exercise Referral Courses
- Become a world-class Sports Massage Therapist
- Become a world-class Yoga Instructor
- Become a world-class Personal Trainer

**premier**  
TRAINING INTERNATIONAL

**Company: Premier Training International Ltd**  
**Location: Nationwide, UK**

- Become a Personal Trainer
- Qualify with Premier Training and work for PURE GYM!
- Become a Gym Instructor - guaranteed interviews!

**HUMAN KINETICS**

**Company: Human Kinetics**  
**Location: Online**

- Conditioning to the Core Online CE Course
- High-Performance Training Sports Online CE Course
- Bodyweight Strength Training Anatomy CE Course

**AMAC**

**Company: Amac Training Ltd**  
**Location: Various, UK**

- Become a Gym Instructor or Personal Trainer

**Diverse Trainers**

**Company: Diverse Trainers**  
**Location: Nationwide, UK**

- Personal Training

To Advertise call  
**+44 (0) 1462 431385**

For more details on the following courses visit  
**[www.leisureopportunities.co.uk](http://www.leisureopportunities.co.uk)**

# Your Staff need love too!



## Could your business perform better?

Better people performance means better results for your business.

CREW training programmes will:

- Inspire great customer service
- Develop interactive talks and shows
- Enhance presentation skills
- Boost retail and FOH confidence
- Improve team morale



**[www.crew.uk.net](http://www.crew.uk.net)**

**[info@crew.uk.net](mailto:info@crew.uk.net)**

**0845 260 4414**





## Mark Warner Summer and Winter Season Vacancies

We are an award winning travel company who offer year round seasonal employment to our staff in picturesque Mediterranean beach front hotels and scenic winter ski resorts. Seasonal life with Mark Warner allows our staff to strike a great balance between working and socialising.

### Waterski and Wakeboard Instructor - Summer 2016 Salary: Competitive

We have a great opportunity for a BWSW UKCC Level 2 Qualified Waterski and Wakeboard Instructor to come and join one of our Mediterranean based teams for the rest of the summer. The ideal candidate will be a newly qualified instructor with at least one or two teaching assignments in their work experience.

### Hotel Manager - Winter 2016/17 Salary: Competitive

We are looking for skilled hotel managers who are looking for a new challenge this coming winter season. The ideal candidate will have experience managing multiple teams across a Chalet-Hotel environment in the Alps as well as being able to demonstrate their own exposure to all relevant departments - front of house, house-keeping, catering, logistics.

Mark Warner offer a comprehensive benefits package: we provide all transport to and from resort, comfortable accommodation, meals and overseas travel insurance. In the summer you can use all resort facilities completely free of charge. In the winter we also provide you with your season lift pass and equipment hire.

Please send your cv and cover letter to [recruitment@markwarner.co.uk](mailto:recruitment@markwarner.co.uk) clearly stating which role you are applying for.



**Ilkley Lawn Tennis & Squash Club** is a thriving sports & fitness club in the heart of the Yorkshire dales. A premier pre Wimbledon tournament & event venue which has just undergone a large £2.5M development project to upgrade the facilities.



We are looking for the following positions:

- Assistant General Manager
- FOH Supervisor
- FOH Assistants
- Assistant Groundsman
- Maintenance P/T
- Admin Assistant P/T
- Cafe bar Assistants
- Group Exercise Instructors
- Fitness Trainers

To apply for any of the above positions please send your cv & cover letter to [Charlie@iltsc.co.uk](mailto:Charlie@iltsc.co.uk)

Fortnightly leisure recruitment, training, property and news publication which gets you the right job or the perfect candidate for your vacancy



subscribe online:  
[www.leisuresubs.com](http://www.leisuresubs.com)

jobs & news  
updated daily  
online

[www.leisureopportunities.com](http://www.leisureopportunities.com)

## SWYDDOG AR DDYLETSWYDD

Cyfeirnod y swydd: CLLS00056CWE

Gwasanaeth: Cyfleusterau, Asedau a Thai

Lleoliad: Canolfan Hamdden y Rhyl

Cyflog: Gradd 6, SCP 24-28, £21,745 - £24,717

Awr yr wythnos: 37

Parhaol / Swydd Fewnol

Mae Hamdden Sir Ddinbych yn un o brif ddarparwyr cyfleusterau chwaraeon a hamdden Gogledd Cymru, â 9 cyfleuster hamdden ar hyn o bryd a gwasanaethau morol a theatrau. Rydym yn defnyddio dull masnachol o reoli cyfleusterau ond rydym yn ceisio darparu cyfleoedd gwyb i bawb.

Mae cyfle ar gael i chwaraewr tîm rhagweithiol ymuno â'n Tîm Rheolwyr Dyletswydd yng Nghanolfan Hamdden y Rhyl - cyfleuster sych/gwlyb prysur gyda 1,000 o aelodau ffitrwydd a rhaglen gwersi nofio brysur iawn.

Bydd angen i chi fod â llygad fanwl, sgiliau gwasanaeth cwsmeriaid rhagorol a brwdfrydedd dros y diwydiant hamdden. Bydd angen i chi osod safonau uchel ym mhob dim rydych yn ei wneud, gan helpu eraill i wneud yr un peth.

Bydd yr unigolyn cywir yn mynd i'r afael â darparu gwasanaeth yn ymarferol ac yn gallu gweithio ar eu liwt eu hunain i gwbllhau tasgau.

Bydd y prif dyletswyddau'n cynnwys rheoli rhaglenni gweithgareddau a chyfleusterau yn y Ganolfan a rheoli a monitro lechyd a Diogelwch a sicrhau ein bod yn darparu gwasanaeth o'r safon orau i bawb

Os oes gennych ddi-ddordeb yn y swydd wag hon, gwnewch gais ar-lein trwy ein gwefan [www.sirddinbych.gov.uk](http://www.sirddinbych.gov.uk) Am ddulliau eraill o wneud cais, cysylltwch â'r Adran Gwasanaethau Cwsmeriaid ar 01824 706100 neu ar e-bost [cysylltwch@sirddinbych.gov.uk](mailto:cysylltwch@sirddinbych.gov.uk)

Mae'n rhaid i CVs fod ynghlwm â ffurflen gais swyddogol Cyngor Sir Ddinbych.

Dyddiad Cau: 25 Medi 2016

## DUTY OFFICER

Job reference: CLLS00056CWE

Service: Facilities, Assets and Housing

Location: Rhyl Leisure Centre

Salary: Grade 6, SCP 24-28, £21,745 - £24,717

Hours per week: 37

Permanent / External vacancy

Denbighshire Leisure is a leading supplier of sports and leisure facilities in North Wales, currently operating 9 leisure facilities plus maritime services and theatres. We take a commercial approach to facility management yet aim to provide excellent opportunities for all.

An opportunity has arisen for a proactive team player to join our Duty Manager Team at Rhyl Leisure Centre - a busy wet/dry facility with 1,000 fitness members and a very busy swimming lesson programme

You will need an eye for detail, have exceptional customer service skills and a passion for the leisure industry. You will need to set high standards in all that you do and help others to do the same.

The right individual will take a hands-on approach to service delivery & be able to work under their own initiative to 'get things done'.

The main duties include the management of facilities & activities programmes within the Centre and for Health and Safety management and monitoring and for ensuring we deliver a first class service for all customers and visitors.

If you are interested in this vacancy, please apply on-line via the website [www.denbighshire.gov.uk](http://www.denbighshire.gov.uk) For alternative methods of applying please contact Customer Services on 01824 706101 or email [hrdirect@denbighshire.gov.uk](mailto:hrdirect@denbighshire.gov.uk)

CVs must be accompanied by a completed Denbighshire County Council Application form.

Closing Date: 25 September 2016



For more details on the following jobs  
visit [www.leisureopportunities.co.uk](http://www.leisureopportunities.co.uk)  
or to advertise call +44 (0)1462 431385



#### Sports Facilities Assistant

Company: New Hall School  
Location: Chelmsford, UK

#### Personal Trainer

Company: énergie group  
Location: Various locations, UK

#### Team Leader

Company: Everyone Active  
Location: Sutton, UK

#### Full-time Receptionist

Company: Everyone Active  
Location: Rotherhithe, London, UK

#### Lifeguard

Company: University of London  
Location: London, UK

#### Lifeguard

Company: Oxford Brookes University  
Location: Oxford, UK

#### Recreation Assistant (Lifeguard)

Company: GLL  
Location: Various locations, UK

#### Personal Trainer

Company: Everyone Active  
Location: Various locations, UK

#### Receptionist (casual)

Company: Parkwood Leisure  
Location: Thetford, UK

#### Health Club Deputy Manager

Company: Livingwell  
Location: Hilton Dartford Bridge, UK

#### Duty Manager

Company: énergie group  
Location: Hemel Hempstead, UK

#### Events Coordinator

Company: Glendale Golf  
Location: Nottingham, UK

#### Operations Manager

Company: Everyone Active  
Location: Staines Upon thames, UK

#### Duty Manager

Company: Parkwood Leisure  
Location: Cardiff, UK

#### Recreation Assistants

Company: Parkwood Leisure  
Location: North Devon, UK

#### Personal Trainers

Company: The Gym Group  
Location: Various locations, UK

#### Fitness Instructor

Company: énergie group  
Location: Buckinghamshire, UK

#### Duty Manager

Company: Impulse Leisure  
Location: Thurrock, Essex, UK

#### Health and Fitness Instructor

Company: University of Warwick  
Location: Coventry, UK

#### Front of House Receptionist

Company: Everyone Active  
Location: St Albans, Herts, UK

#### Apprenticeship in Fitness Instructing

Company: énergie group  
Location: Buckinghamshire, UK

#### Swimming Teachers

Company: Everyone Active  
Location: Various locations, UK

#### Lifeguards

Company: Everyone Active  
Location: Various locations, UK

#### Swimming Teachers

Company: Everyone Active  
Location: Peckham, London, UK

#### Relief Duty Manager

Company: Everyone Active  
Location: Spelthorne, UK

#### Swim Teacher

Company: Everyone Active  
Location: Various locations, UK

#### Business Development Exec

Company: Wexer Virtual  
Location: London, UK

#### General Manager

Company: énergie group  
Location: Stevenage, UK

#### Recreation Assistant

Company: Legacy Leisure  
Location: South Northamptonshire, UK

#### Front Desk Manager

Company: Equinox  
Location: London, UK

#### Front Desk Associate

Company: Equinox  
Location: London, UK

#### Fitness Instructors

Company: Highgate School  
Location: London N6, UK

#### P/T Crèche Supervisor

Company: Everyone Active  
Location: Fareham, Hampshire, UK

#### Area Membership Consultant

Company: Everyone Active  
Location: Scarborough, UK

#### Membership Coordinator

Company: Everyone Active  
Location: Nuneaton and Bedworth, UK

#### Duty Managers

Company: Magna Vitae  
Location: Lincolnshire, UK

#### Sports Assistant

Company: University of Bath  
Location: Bath, UK

#### Trainee Duty Manager

Company: Parkwood Leisure  
Location: Thetford, UK

#### Recreation Assistant

Company: Parkwood Leisure  
Location: Thetford, UK

#### Sports Assistant

Company: University of Bath  
Location: Bath, UK

#### Membership Coordinator

Company: Everyone Active  
Location: Nuneaton, UK

#### Fitness Adviser

Company: University of Bristol  
Location: Bristol, UK

#### P/T Swimschool Coordinator

Company: Aspire Leisure Centre  
Location: Middlesex, UK

#### Administration Assistant

Company: Aspire Leisure Centre  
Location: Middlesex, UK

#### Management Positions

Company: 360 Play  
Location: Various, UK

#### Field Sales Product Specialist

Company: Perform Better Limited  
Location: Warwickshire, UK

#### Aquazone Swimming Instructor

Company: Legacy Leisure  
Location: Penarth, UK

#### Team Leader

Company: Everyone Active  
Location: Aylesbury, UK

#### Leisure Assistant - Grade 5

Company: Aston University  
Location: Birmingham, UK

#### Swim Manager

Company: Everyone Active  
Location: Melton Mowbray, UK

#### Senior Recreation Assistant

Company: GLL  
Location: Greenwich, UK

#### Membership Consultant

Company: Everyone Active  
Location: Various locations, UK

#### Area Membership Consultant

Company: Everyone Active  
Location: Various, UK

#### Membership Consultant

Company: Everyone Active  
Location: Chichester, UK

#### Leisure Attendant

Company: New Forest District Council  
Location: Ringwood, UK

#### Fitness Instructor

Company: truGym  
Location: Peterborough, UK

#### Swimming Teachers

Company: Everyone Active  
Location: Sutton, UK

#### Team Leader

Company: Everyone Active  
Location: Stowmarket, UK

#### Customer Advisor

Company: Parkwood Leisure  
Location: Bristol, UK

#### Water-ski Instructor

Company: Mark Warner Holidays  
Location: Greece, Sardinia and Corsica

#### Indoor Play Area Manager

Company: Brean Play  
Location: Somerset, UK

#### Swimming Teachers

Company: Everyone Active  
Location: Sutton, UK

#### Business Support Manager

Company: Uni of Birmingham Sport  
Location: Birmingham

#### Duty Manager

Company: Parkwood Leisure  
Location: Sidcup, UK

#### Marketing Manager

Company: Legend Club Management  
Location: York based, UK

#### National Trainer

Company: énergie group  
Location: Milton Keynes, UK

#### Regional Sales Manager

Company: Legend Club Management  
Location: Scotland, UK

#### Duty Manager

Company: Legacy Leisure  
Location: Bicester, UK

#### Lead Swim Teacher

Company: Becky Adlington's Swim Stars  
Location: Various, UK

#### Membership Consultant

Company: Everyone Active  
Location: Aylesbury, UK

#### Swim Manager

Company: Everyone Active  
Location: Camberwell, London, UK

#### General Assistant

Company: GLL  
Location: Various locations, UK

#### Membership Advisor

(Maternity Cover)  
Company: Parkwood Leisure  
Location: Cardiff, UK

#### Store Manager

Company: Fitness Superstore  
Location: Leeds

#### Wellbeing Officer - Sport

Company: Basingstoke and Deane Borough Council  
Location: Basingstoke

#### Senior Recreation Assistant

Company: GLL  
Location: Woolwich, London, UK

#### General Manager

Company: GLL  
Location: Chesham - Chilterns, UK

#### Centre Manager

Company: Legacy Leisure  
Location: Bicester, UK

#### Lifeguard

Company: Loughborough University  
Location: Loughborough, UK

#### Health Club Manager

Company: Livingwell  
Location: Maidstone, UK



### Partner Support Assistant

Company: Move GB  
Location: Bath, UK

### Sports Leader

Company: Everyone Active  
Location: Redcar, Cleveland, UK

### Shop Associate

Company: Equinox  
Location: London, UK

### Swimming instructor

Company: énergie group  
Location: Leighton Buzzard, UK

### Lifeguard

Company: Everyone Active  
Location: Redcar & Cleveland, UK

### Macmillan Move More Physical Activity Coordinator

Company: Sports Partnership Herefordshire and Worcestershire  
Location: Worcester, UK

### Sports Facilities Manager

Company: Thinking Schools Academy  
Location: Medway, UK

### Part Time Fitness Motivator

Company: Everyone Active  
Location: Southwark, London, UK

### Duty Manager

Company: Parkwood Leisure  
Location: Hengrove Park, Bristol, UK

### Trainee Duty Manager

Company: Parkwood Leisure  
Location: Hengrove Park, Bristol, UK

### Recreation Apprenticeship

Company: Everyone Active  
Location: Ware, Herts, UK

### P/T Fitness Motivator

Company: Everyone Active  
Location: Ware, Herts, UK

### Fitness Instructor (16hrs)

Company: énergie group  
Location: Dundee East, UK

### Recreation Assistants

Company: Parkwood Leisure  
Location: Bristol, UK

### Sales Manager

Company: Soho Gyms  
Location: London, UK

### Personal Trainers Wanted

Company: Soho Gyms  
Location: London, UK

### Front of House Receptionist

Company: Everyone Active  
Location: St Albans, UK

### Sales Manager

Company: énergie group  
Location: Forest Hill, UK

### Customer Service Advisor

Company: Move GB  
Location: Bath, UK

### Membership Consultant

Company: Everyone Active  
Location: Various locations, UK

### Duty Manager

Company: Everyone Active  
Location: Spelthorne, UK

### General Manager

Company: The Gym Group  
Location: Rotherham, UK

### Swimming Teachers

Company: Everyone Active  
Location: Fareham, UK

### Club Promotional Staff

Company: énergie group  
Location: Forest Hill, UK

### Business Dev Manager

Company: HR Solutions  
Location: Southampton

### Front Of House Supervisor

Company: Ilkley Lawn Tennis Club  
Location: W Yorks, UK

### Assistant General Manager

Company: Ilkley Lawn Tennis Club  
Location: W Yorks, UK

### Casual Fitness Instructor

Company: Parkwood Leisure  
Location: Bristol, UK

### Technical Manager

Company: Everyone Active  
Location: Plymouth, UK

### Group Exercise Instructors

Company: Everyone Active  
Location: Fareham, UK

### Golf Services Supervisor

Company: Glendale Golf  
Location: Nottingham, UK

### Fitness Instructor

Company: énergie group  
Location: Milton Keynes, UK

### Recreation Assistant

Company: Everyone Active  
Location: Studley Leisure Centre, UK

### Self-Employed

### Personal Trainers

Company: Everyone Active  
Location: Loughton, Essex, UK

### Sales Manager

Company: Conscious Water  
Location: London & Home Counties, UK

### Level 2 Gymnastics Coach

Company: Everyone Active  
Location: Redcar, Cleveland, UK

### Area Sales Manager

Company: eGym  
Location: Nationwide (UK travel), UK

### Personal Trainer

Company: Amac Training Ltd  
Location: London, surrounding areas

### General Manager

Company: Xercise4Less  
Location: Hartlepool, Wakefield UK

### Sales and Marketing Manager

Company: Xercise4Less  
Location: Various locations, UK

### Personal Trainer

Company: Xercise4Less  
Location: Nationwide, UK

### General Managers

Company: The Gym Group  
Location: Rotherham

### Impact Sales Consultant

Company: Xercise4Less  
Location: National role, UK

### Membership Consultant

Company: Xercise4Less  
Location: Various locations, UK

### Specialise with our GP Exercise Referral Courses

Company: YMCAfit  
Location: Nationwide, UK

### Customer Service/Front of House Assistant

Company: Everyone Active  
Location: Various locations, UK

### Multi-Skill Diploma apprenticeship

Company: Everyone Active  
Location: Various locations, UK

### GP Exercise Referral

Company: Focus Training  
Location: Nationwide, UK

### Spa Therapists

Company: Hand Picked Hotels  
Location: Various, UK

### Beauty Therapist

Company: Wyboston Lakes  
Location: Wyboston, Bedfordshire, UK

### Spa Therapist

Company: Bedford Lodge Hotel  
Location: Newmarket, UK

### Spa Therapist

Company: Lifehouse Spa and Hotel  
Location: Essex, UK

### Holistic Spa Therapist and Senior Spa Therapist

Company: Spa Shell  
Location: Ludlow, Shropshire, UK

### Spa Therapist

Company: Coworth Park  
Location: Ascot, Berkshire, UK

### Resort Facilities Supervisor

Company: Legoland  
Location: California, United States

### Studio Manager

Company: Madame Tussauds  
Location: Nashville, United States

### Technical Manager

Company: Legoland Discovery Centre  
Location: Philadelphia, United States

### Creative LEGOLAND Parks

Company: Merlin Entertainments  
Location: London, UK

### Social Media Manager

Company: Legoland  
Location: Florida, United States

### Studio Artist

Company: Madame Tussauds  
Location: New York NY, United States

### Hotel Manager

Company: Mark Warner Holidays  
Location: Europe

### Duty Manager

Company: Royal Armouries Museum  
Location: Leeds

### Head of Group Resourcing

Company: Merlin Entertainments  
Location: Poole, UK

### Global Brand Marketing Exec

Company: Sea Life  
Location: Westminster, London, UK

### Researcher - Creative Media

Company: Merlin Entertainments  
Location: London, UK

### Researcher - Creative Media - (Hindi speaking)

Company: Merlin Entertainments  
Location: London, UK

### Operations Manager

Company: Legoland Discovery Centre  
Location: Philadelphia, United States

**leisure opportunities joblink**

**BOOK A JOBLINK Call: +44 1462 471747**  
and start getting applications for your jobs IMMEDIATELY!

GO TO [WWW.LEISUREOPPORTUNITIES.CO.UK](http://WWW.LEISUREOPPORTUNITIES.CO.UK) AND CLICK ON THE LINK TO SEE THE LATEST JOBS FROM...



## 'Smart investment' needed for cycling

British Cycling will lobby for "smart investment and better infrastructure" in a bid to capitalise on Team GB's performance at Rio 2016.

Great Britain's track cycling team smashed UK Sport's maximum target of 10 medals by going one better, with standout performances by Laura Trott and Jason Kenny.

The national governing body's (NGBs) president Bob Howden said that cycling had "once again captured the nation's imagination" and that there was a "growing appetite to get more people on bikes".

"We will continue to campaign for stronger political leadership, smart investment and better infrastructure," he added.

Over the past seven years, British Cycling has ploughed more than £10m of Sport England funds into the building and renovation of purpose-built facilities.

However, the body's chief executive Ian Drake said there was "still work to do in order to create a comprehensive network of facilities", while in April one of Team GB's gold medal-winning athletes, Joanna Rowsell-Shand, told



Howden said cycling had 'captured the nation's imagination' in Rio

*Leisure Opportunities* that more facilities would improve potential athletes' chances.

"I'd like to see more facilities in the UK," she said. "We've currently got five indoor velodromes, but [I want] more road circuits. It must be so easy to build tarmac roads, I don't understand why we don't have more of them."

British Cycling received £30.3m from UK Sport and £32m from Sport England over the organisations' latest funding cycles.

Details: [http://lei.sr?a=Z4P2s\\_O](http://lei.sr?a=Z4P2s_O)

## FA looks to ramp up grassroots scheme

*Continued from front cover*

St George's Park Sheffield Graves has already opened, with a second Sheffield centre in Thorncliffe opening in a month's time.

The programme is now expected to be pushed out nationwide, with the funding partners – and the Premier League – ploughing in £200m (US\$261.9m, €234.4m) to replicate the model in other cities. Planning applications are now being considered for proposed sites in Liverpool and London.

The move is part of the governing body's drive to increase the number of quality facilities for grassroots football in inner cities, and subsequently boost the number of people playing the sport at community level.

Artificial pitches will offer double the amount of playing time that can be accommodated on natural pitches. They are also unlikely to become susceptible to being frozen or waterlogged.



FA chief executive Martin Glenn said the centres marked the start of 'something big' for grassroots

The facilities in Sheffield will host league matches for up to five resident clubs. Once the centres are fully-operational, they will be open to the wider public. Designed to be self-sustaining, the centres will be operated via a charitable ownership model.

Details: [http://lei.sr?a=r5x4Z\\_O](http://lei.sr?a=r5x4Z_O)

- Arts & Business +44 (0)20 7378 8143  
[www.artsandbusiness.org.uk](http://www.artsandbusiness.org.uk)
- ALVA +44 (0)20 7222 1728  
[www.alva.org.uk](http://www.alva.org.uk)
- Arts Council +44 (0)20 7333 0100  
[www.artscouncil.org.uk](http://www.artscouncil.org.uk)
- ASVA +44 (0)1786 475152  
[www.asva.co.uk](http://www.asva.co.uk)
- BALPPA +44 (0)20 7403 4455  
[www.balppa.org](http://www.balppa.org)
- BHA +44 (0)845 880 7744  
[www.bha.org.uk](http://www.bha.org.uk)
- BiSL +44 (0)20 8780 2377  
[www.bisl.org](http://www.bisl.org)
- CMAE +44 (0)1334 460 850  
[www.cmaeurope.org](http://www.cmaeurope.org)
- CIMSPA +44 (0)1509 226 474  
[www.cimspa.co.uk](http://www.cimspa.co.uk)
- CPRE +44 (0)20 7981 2800  
[www.cpre.org.uk](http://www.cpre.org.uk)
- English Heritage +44 (0)870 333 1181  
[www.english-heritage.org.uk](http://www.english-heritage.org.uk)
- FSPA +44 (0)2476 414999  
[www.sportsandplay.com](http://www.sportsandplay.com)
- Fields in Trust +44 (0)20 7833 5360  
[www.fieldsintrust.org](http://www.fieldsintrust.org)
- HHA +44 (0)20 7259 5688  
[www.hha.org.uk](http://www.hha.org.uk)
- IAAPA +1 703 836 4800  
[www.iaapa.org](http://www.iaapa.org)
- IEAP +44 (0)1403 265 988  
[www.ieap.co.uk](http://www.ieap.co.uk)
- Institute of Hospitality +44 (0)20 8661 4900  
[www.instituteofhospitality.org.uk](http://www.instituteofhospitality.org.uk)
- LPF +44 (0)1462 471932  
[www.leisurepropertyforum.org](http://www.leisurepropertyforum.org)
- Natural England +44 (0)845 600 3078  
[www.naturalengland.org.uk](http://www.naturalengland.org.uk)
- People 1st +44 (0)870 060 2550  
[www.people1st.co.uk](http://www.people1st.co.uk)
- REPs +44 (0)20 8686 6464  
[www.exerciseregister.org](http://www.exerciseregister.org)
- SAPCA +44 (0)24 7641 6316  
[www.sapca.org.uk](http://www.sapca.org.uk)
- Sports Aid +44 (0)20 7273 1975  
[www.sportsaid.org.uk](http://www.sportsaid.org.uk)
- Sport and Recreation Alliance  
+44 (0)20 7976 3900  
[www.sportandrecreation.org.uk](http://www.sportandrecreation.org.uk)
- Sport England +44 (0)8458 508 508  
[www.sportengland.org](http://www.sportengland.org)
- Springboard +44 (0)20 7529 8610  
[www.springboarduk.org.uk](http://www.springboarduk.org.uk)
- SkillsActive +44 (0)33 0004 0005  
[www.skillsactive.com](http://www.skillsactive.com)
- Tourism Management Institute  
+44 (0)1926 641506  
[www.tmi.org.uk](http://www.tmi.org.uk)
- Tourism Society +44 (0)20 8661 4636  
[www.tourismsociety.org](http://www.tourismsociety.org)
- ukactive +44 (0)20 7420 8560  
[www.ukactive.org.uk](http://www.ukactive.org.uk)
- VisitBritain +44 (0)20 7578 1000  
[www.visitbritain.com](http://www.visitbritain.com)
- World Leisure +1 250 497 6578  
[www.worldleisure.org](http://www.worldleisure.org)